

REFERENCE

目前在金隅集团调试应用一台（如图3）。

Presently there is a TSMS3000 clinker weigh scale under commissioning at Jiyu Cement Group (Shown in Figure 3).



图3 TSMS3000熟料计量秤现场应用图
Figure 3 TSMS3000 Clinker Weigh Scale under commissioning

TSMS3000熟料计量秤

TSMS3000 CLINKER WEIGH SCALE

联系我们 Contact Us

天津
地址：天津市北辰区引河里北道1号
邮编：300400
电话：0086(22)26915233
传真：0086(22)26915452
网址：Http://www.sinoma-tcdri.cn

Tianjin
Address: No.1, Yinheli Bei Road, Beichen District,
Tianjin P.R. China
Post code: 300400
Tel: 0086(22)26915233
Fax: 0086(22)26915452
Website: Http://www.sinoma-tcdri.cn

北京
地址：北京市经济技术开发区隆庆街7号
邮编：100176
电话：0086(10) 67285071
传真：0086(10)67285001
网址：Http://www.cbmi.com.cn

Beijing
Address :7th, LONGQING Road, Beijing Economic and Technological
Development Area, P.R. China
Post code: 100176
Tel: 0086(10) 67285071
Fax: 0086(10)67285001
Website: Http://www.cbmi.com.cn



主要技术优势 Main technical advantages

- 连续输送，静态计量，性能稳定，长期工作可靠性高
- 适应2000~6000t/d新建或改造熟料生产线
- 计量精度高：静态0.1%，自动0.2%
- 计量能力：100~350t/h 最大称量：3000kg/次（以容重1.40t/m³计）
- 安全系数高：由于增加旁路管道，在非计量时段或紧急情况下可以通过旁路下料，不影响正常生产
- continuous conveying, static weighing, stable operation and long term reliability
- adapt to 2000~6000t/d new or modified cement projects
- high accuracy: static 0.1%, automatic 0.2%
- capacity: 100~350t/h max.: 3000kg/time (bulk density at 1.40t/m³)
- high safety factor: at non-weighing or emergency case, clinker can be conveyed from bypass pipeline

天津水泥工业设计研究院有限公司

Tianjin Cement Industry Design & Research Institute Co.,Ltd.

1 概述

GENERAL

水泥生产过程中，熟料计量最能反映水泥生产的状况，是产量考核、热工标定及节能降耗的重要依据。由于熟料温度高、磨蚀性强及运行环境恶劣等特点，水泥生产企业所使用的例如“核子秤”、“冲板流量计”等设备也由于放射污染或结构缺陷而不能长期使用。目前许多企业采用生料折合率方式来估算熟料产量，误差较大。

TSMS3000水泥熟料计量秤（如图1）是目前国内第一款专门针对水泥熟料的特性而设计开发的一种对熟料进行非连续累加自动计量类产品。它充分考虑了水泥熟料输送现场粉尘较大、环境温度高、设备零部件磨损性较严重等特性，采取了相应的防护措施，具有很强的适用性。

During cement production, the weighing of clinker is the best parameter to reflect the situation of cement production, as well as the important basis to check the capacity, thermal calibration, energy saving and so on. Owing to the feature of clinker including high temperature, strong abrasiveness, and worse working condition, cement producers used to use nuclear scale, impact flowmeter and the similar equipments. But due to radioactivity or structural defect of such equipments, they are not able to operate for long time. Presently, many cement producers generally estimate clinker capacity by raw material conversion rate, but in large error. TSMS3000 clinker weigh scale (See Figure 1) is the first developed and designed automatic discontinuous accumulated weigh scale at home particular to clinker property. It fully considers working condition of clinker and takes relevant protective measures on it.



图1 TSMS3000熟料计量秤
Figure 1 TSMS3000 Clinker Weigh Scale

2 产品简介

PRODUCT INTRODUCTION

它的组成主要由秤上斗及旁路部分（可以根据现场条件进行非标制作）、称量仓、校秤装置、秤体支架及称重控制系统等。它的外形尺寸如图2所示，由于占用空间小，除了适用于新建生产线外，还极易适合改造类项目。

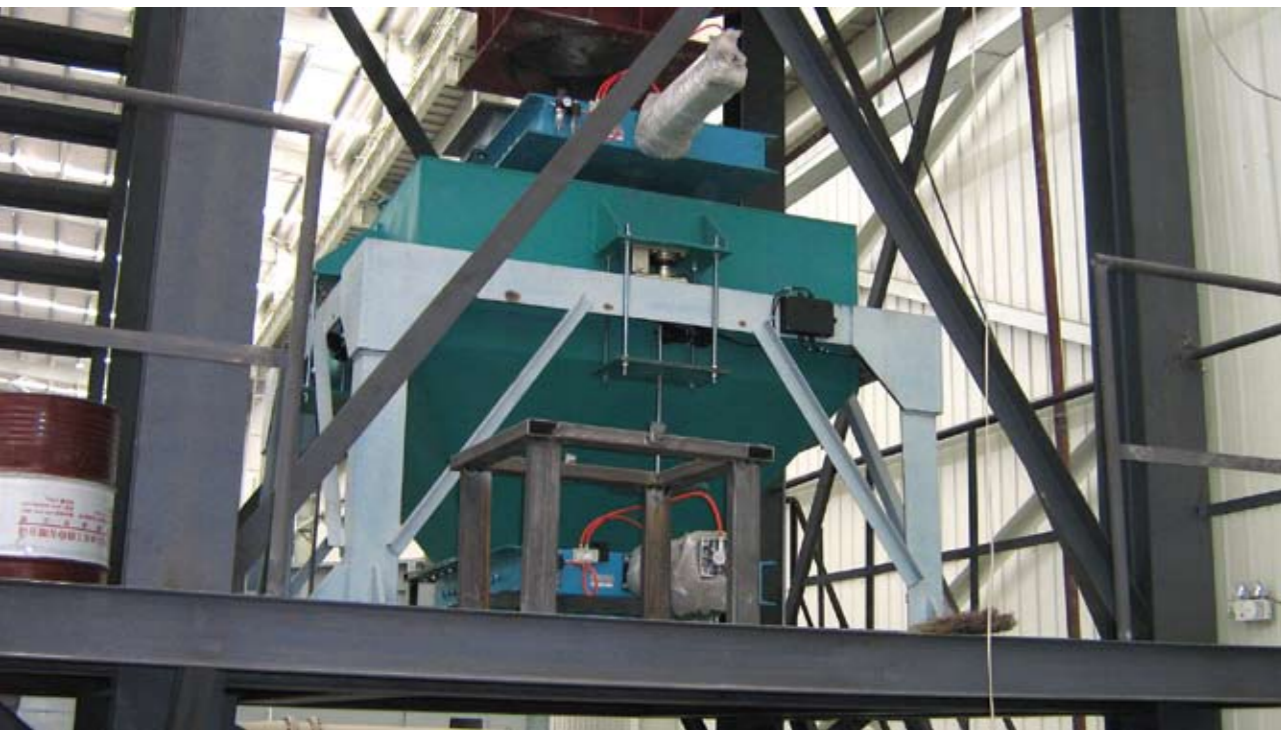
It is composed of hopper, bypass (fabricated according to sit condition), weighing bin, calibration device, scale support, electronic control system and so on. Its external dimension is shown as Figure 2. Due to taking less space, it is appropriate to new cement production lines as well as many modification projects.



图2 TSMS3000熟料秤外形尺寸图
Figure 2 The external dimension of TSMS3000 Clinker Weigh Scale

3 特点与性能指标

CHARACTERISTICS AND PERFORMACNE

TSMS3000熟料秤能自动连续地对熟料产量进行累加统计，这样能够给予热工标定及能耗计算提供更为精确的数据，有利于企业进行节能降耗；同时，也可以进行班组产量考核，提高生产效率。它的特点与指标如下：

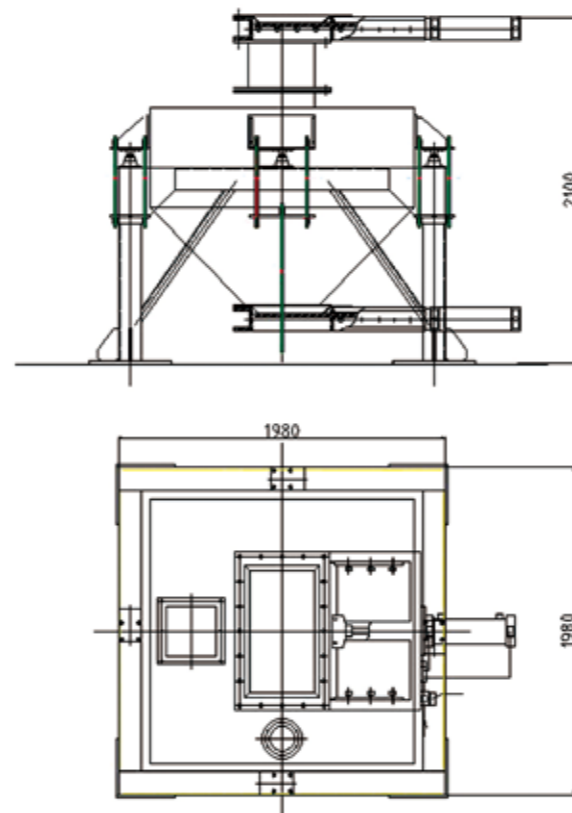
- 连续输送，静态计量，性能稳定，长期工作可靠性高
- 适应2000~6000t/d新建或改造熟料生产线
- 计量精度高：静态0.1%，自动0.2%
- 计量能力：100~350t/h 最大称量：3000kg/次（以容重1.40t/m³计）
- 传感器数量：4支
- 气源：压力：0.5~0.6MPa
- 安全系数高：由于增加旁路管道，在非计量时段或紧急情况下可以通过旁路下料，不影响正常生产。
- 售后服务好：具有稳定的技术服务人员，可提供足够的备品备件和及时完善的技术服务。

TSMS3000 clinker weigh scale can automatically do discontinuous accumulation of clinker capacity. It can not only provide reliable and accurate parameter of thermal calibration and heat consumption calculation, but good for energy saving. Besides, it can test the shift capacity and improve production efficiency. Its characteristics show as the following.

- continuous conveying, static weighing, stable operation and long term reliability
- adapt to 2000~6000t/d new or modified cement projects
- high accuracy: static 0.1%, automatic 0.2%
- capacity: 100~350t/h max.: 3000kg/time (bulk density at 1.40t/m³)
- quantities of sensors: 4
- air pressure: 0.5~0.6MPa
- high safety factor: at non-weighing or emergency case, clinker can be conveyed from bypass pipeline
- good after-sales service: high-quality employees, enough spare parts and timely technical services